

glezman surveying, inc.

1938 Old River Road
Montgomery, Texas 77356

936-582-6340
Fax: 582-6344

5.614 ACRES
GEORGE W. WILSON SURVEY, A-628
TRINITY COUNTY, TEXAS

Being 5.614 acres of land, situated in the George W. Wilson Survey, Abstract Number 628 in Trinity County, Texas and being out of and a part of the J. Randal Bays 7.835 acre tract as described in Volume 869, Page 253 of the Official Public Records of Trinity County, Texas: said 5.614 acres being more particularly described by metes and bounds as follows with all bearings referenced to the West line of the 7.835 acre tract as found monumented on the ground:

BEGINNING at a ½ inch iron rod, found for the Southwest corner of the herein described tract and the Northwest corner of the Art Walker Auto and ATV Inc., called 2.156 acre tract as recorded in Volume 755, Page 802 of the Official Public Records of Trinity County, Texas, in the East line of the Mark Tatom 2.000 acre tract as recorded in Volume 578, Page 136 Official Public Records of Trinity County, Texas;

THENCE North 00°27'43" East, a distance of 439.27 feet along the West line of the 7.835 acre tract (Deed call: North 00°26'30" East), to a 5/8 inch iron rod, found for the Northwest corner of the herein described tract and Northeast corner of the Mark Tatom 2.5 acre tract as recorded in Volume 578, Page 139 Official Public Records of Trinity County, Texas, and being located in the South line of the XG Ventures called 14.250 acre tract recorded in Volume 879, Page 136 Official Public Records of Trinity County, Texas;

THENCE South 84°46'50" East, along the South line of the called 14.250 acre tract and North line of the 7.835 acre tract, passing at 122.5 feet, an 5/8 inch iron rod, found; in all, a distance of 542.03 feet along the North line of the herein described tract (Deed call: South 85°30'00" East, 540.45 feet) to a 5/8 inch iron rod with a survey cap, found for the Northeast corner of the herein described tract, in the West line of State Highway 19;

THENCE South 09°03'04" East, a distance of 56.38 feet along the West line of State Highway 19 to the beginning of a curve to the left;

THENCE along the East line of the herein described tract and the West line of State Highway 19 with a curve to the left, having as its elements: a central angle of 01°30'33", a radius of 14,209.29 feet, an arc length of 374.29 feet and a chord bearing South 05°23'52" East, 374.28 feet to a 5/8 inch iron rod with survey cap, found for the Southeast corner of the herein described tract and the Northeast corner of the Art Walker Auto and ATV Inc., 2.156 acre tract;

THENCE North 86°15'53" West, a distance of 588.65 feet along the North line of the 2.156 acre tract, severing the 7.835 acre tract (Deed call: South 86°18'11" East, 588.49 feet), back to the Point of Beginning and containing 5.614 acres (244,561 square feet) of land, based on the survey and plat prepared by Glezman Surveying, Inc., dated June 5, 2013.

Michael Glezman
Registered Professional Land Surveyor
Texas Registration No. 4627

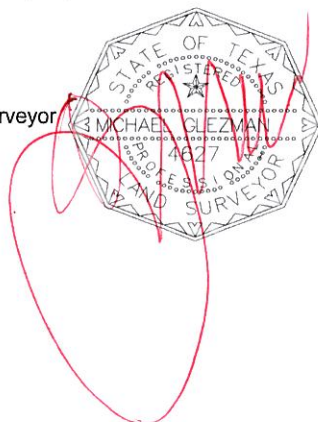

Date: 12/17/2012
8.162 Acres Sec 5